

# HSV Filter Housings

Vent applications



- Direct connection to tank boss allows housing to be self-supportive
- Easy assembly and maintenance
- STANDARD product
  - Standard surface finish and tri-clamp connection
- PLUS product
  - Available as STANDARD or for Atex applications
  - Standard, sanitary and sanitary electropolished surface finishes available
  - Connection choices

(Also see HSVLP L-Port Datasheet)

## Specification

### STANDARD Range

#### Materials of Construction

- Housing: 316L Stainless Steel
- Seals: Silicone FDA
- Clamps: 304 Stainless Steel

#### Surface Finish

- Internal: As welded
- External: Polished 0.8  $\mu\text{m}$  (32  $\mu\text{ln}$  Ra)

All finishes pickled and passivated

### PLUS Range

#### Materials of Construction

- Housing: 316L Stainless Steel
- Seals: EPDM FDA  
Silicone FDA  
Viton® / FKM FDA

Note: Seal used only to position bowl clamp arrangement.

- Clamps: 304 Stainless Steel

#### Standard Surface Finish

- Internal: As welded  
Pickled and Passivated
- External: Polished 0.8  $\mu\text{m}$  Ra (32  $\mu\text{ln}$  Ra)

#### Sanitary Finish

- Internal: Polished 0.4  $\mu\text{m}$  Ra (16  $\mu\text{ln}$  Ra)
- External: Polished 0.25  $\mu\text{m}$  Ra (10  $\mu\text{ln}$  Ra)

#### Sanitary Electropolished Finish

- Internal: Polished 0.4  $\mu\text{m}$  Ra (16  $\mu\text{ln}$  Ra) and Electropolished
- External: Polished 0.25  $\mu\text{m}$  Ra (10  $\mu\text{ln}$  Ra)

### Welding

All assembly welds are full penetration. All welds are crevice and undercut free. Weld finish and detail drawings available upon request.

### Certification

Supplied as standard with vessel inspection certificate

### Material Test Certification

EN10204 3.1 supplied upon request.

### Recommended Operation Guidelines

#### Sizing

Sizing vent vessels particularly for vacuum sensitive tanks can require specialist advice. It is important that VENT housings are sized on maximum gas flow capacity under actual operation conditions.

#### Vacuum Protection

Where a tank is vacuum sensitive, there is a risk of tank collapse. In such cases the fitting of an appropriately rated bursting disc (or similar) and, if necessary a pressure relief valve, is highly recommended.

## Physical Characteristics

Bowl Height	Dimensions (mm)			Typical Weight
	'A'	'B'	'C'	
A Size 125 mm [5"]	75 mm [2.9"]	195 mm [7.7"]	130 mm [5.1"]	1.0 Kg [2.2lbs]
B Size 65 mm [2½"]	75 mm [2.9"]	140 mm [5.5"]	70 mm [2.8"]	0.9 Kg [1.9lbs]
125 mm [5"]	132 mm [5.2"]	242 mm [9.5"]	194 mm [7.6"]	2.2 Kg [4.8 lbs]
250 mm [10"]	132 mm [5.2"]	392 mm [15.4"]	313 mm [12.3"]	2.8 Kg [6.1 lbs]
500 mm [20"]	132 mm [5.2"]	642 mm [25.3"]	561 mm [22.1"]	3.8 Kg [8.3 lbs]
750 mm [30"]	132 mm [5.2"]	890 mm [35.0"]	809 mm [31.8"]	4.8 Kg [10.6 lbs]
1000 mm [40"]	132 mm [5.2"]	1138 mm [44.8"]	1057 mm [41.6"]	5.8 Kg [12.8 lbs]

Dimensions shown are based on the STANDARD range. For accurate dimensions, please contact Parker donnick hunter.

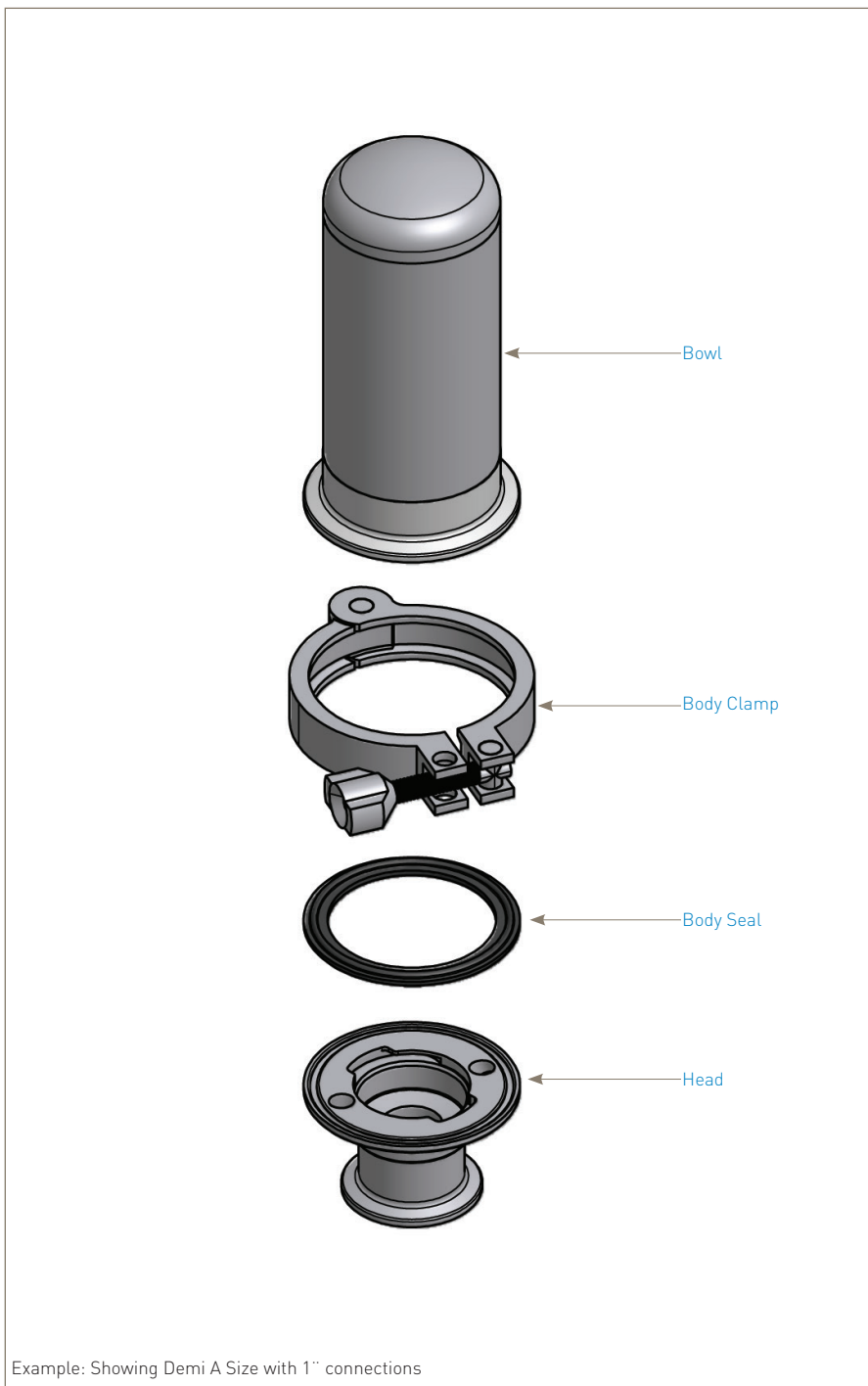
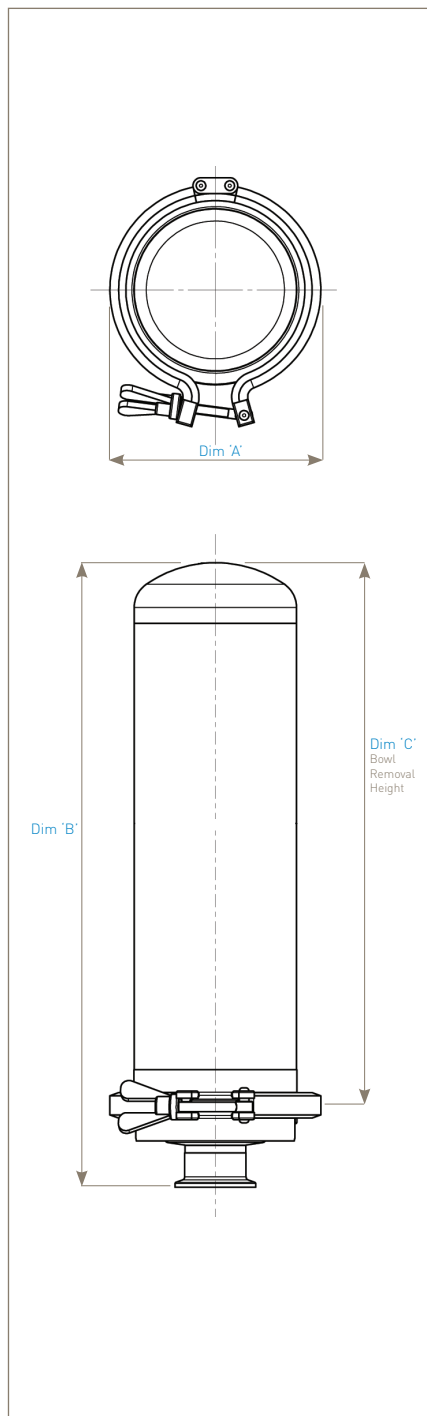

Example: Showing Demi A Size with 1" connections

The PLUS product range is available with many options of connections, vents, drains, surface finish, seals classification, etc. Please see product coding.

Note: All housings are full vacuum rated.

# HSV Filter Housings

Vent applications



## STANDARD Range - K to 20"

HSV  01   -  -

Code   Vessel Class	Code   Length (Nominal)	Code   Connection Size	Code   Standard	Code   Cartridge	Code   Seal
DH Vent Housing	K 5" (125 mm) 1 10" (250 mm) 2 20" (500 mm)	Y 1 1/2" (38.1 mm)	T Tri-Clamp®	C 226	S Silicone

## STANDARD Range - Demi A & B

HSV  01   -  -

Code   Vessel Class	Code   Length (Nominal)	Code   Connection Size	Code   Standard	Code   Cartridge	Code   Seal
DH Vent Housing	A 5" (125 mm) B 2 1/2" (65 mm)	B 1" (25.4 mm)	T Tri-Clamp®	T 126	S Silicone

## PLUS Range - K to 40"

HSV  01      -  -

Code   Vessel Class	Code   Length (Nominal)	Code   Connection Size	Code   Standard	Code   Cartridge	Code   Seal	Code   Surface Finish	Internal	External	Code   Tagged
DH Standard AT ATEX	K 5" (125 mm) 1 10" (250 mm) 2 20" (500 mm) 3 30" (750 mm) 4 40" (1000 mm)	C 2" (50.8 mm) Y 1 1/2" (38.1 mm)	B BSPP (F) / ISO 228 D DIN11851(M) F ANSI RF150 L ISO / DIN PN16 N NPT (F) T Tri-Clamp® W Butt Weld BS4825 Pt. 1	C 226	E EPDM P PTFE S Silicone V Viton® / FKM	B Sanitary I Standard P Sanitary Electropolished	0.4 µm As Welded	0.25 µm 0.8 µm 0.4 µm EP	T Yes X No

For Tagged Options customer identification numbers required at time of ordering

## PLUS Range - Demi A & B

HSV  01     -  -

Code   Vessel Class	Code   Length (Nominal)	Code   Connection Size	Code   Standard	Code   Cartridge	Code   Seal	Code   Surface Finish	Internal	External	Code   Tagged
DH Standard AT ATEX	A 5" (125 mm) B 2 1/2" (65 mm)	B 1" (25.4 mm)	B BSPP (F) / ISO 228 D DIN11851(M) F ANSI RF150 L ISO / DIN PN16 N NPT (F) T Tri-Clamp®	T 126	E EPDM P PTFE S Silicone V Viton® / FKM	B Sanitary I Standard P Sanitary Electropolished	0.4 µm As Welded	0.25 µm 0.8 µm 0.4 µm EP	T Yes X No

For Tagged Options customer identification numbers required at time of ordering

Stäubli™ is a trademark of Stäubli AG.

Tri-Clamp® is a trademark of Alfa-Laval, Inc.

Viton® is a registered trademark of DuPont Performance Elastomers L.L.C..

Note: All Tri-Clamp® connections conform to BS4825 Pt. 3

Parker domnick hunter has a continuous policy of product development and although the Company reserves the right to change specifications, it attempts to keep customers informed of any alterations. This publication is for general information only and customers are requested to contact our Process Filtration Sales Department for detailed information and advice on a products suitability for specific applications. All products are sold subject to the company's standard conditions of sale.

DS\_FBH\_07\_01/14 Rev. 1B

PROSEP FILTER SYSTEMS LTD  
Unit G19  
River Bank Way  
Lowfields Business Park  
Elland  
West Yorkshire  
HX5 9DN

**Tel: 01422 377367**

**Fax: 01422 377369**

Email: [enquiries@prosep.co.uk](mailto:enquiries@prosep.co.uk)

[www.prosep.co.uk](http://www.prosep.co.uk)

**Map and Directions to Prosep Filters Limited**

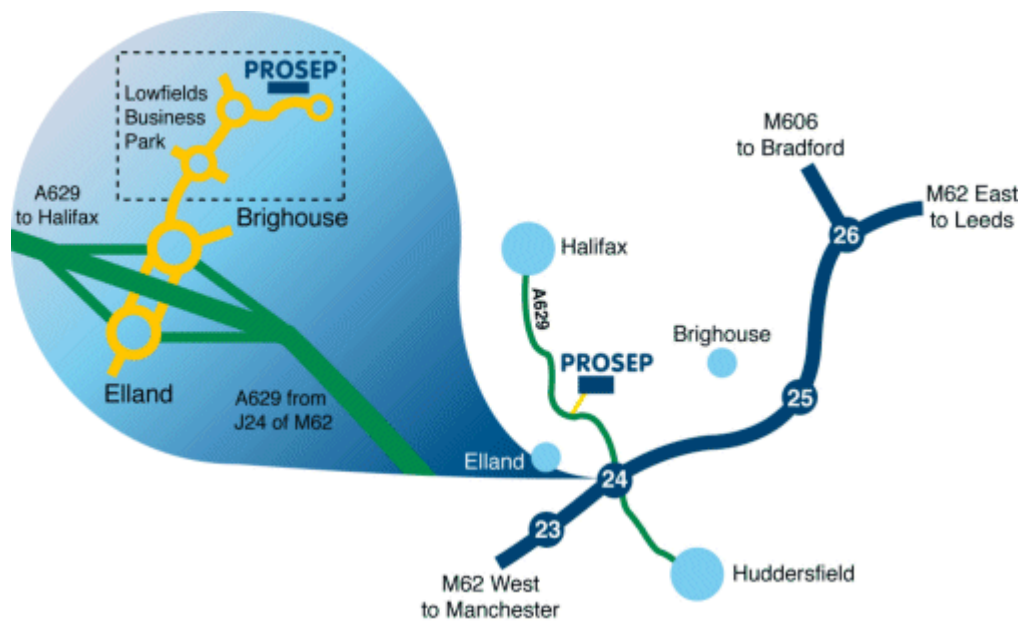

Leave M62 at Junction 24.

At roundabout adjacent to Cedar Court Hotel take 2nd exit onto dual carriageway (A629), signposted Halifax.

Take 1st exit slip road.

At roundabout at end of sliproad, take 3rd exit off.

This is the entrance to Lowfields Business Park.

Proceed straight over 1st roundabout.

At next roundabout take 2nd exit onto River Bank Way - Prosep Filters can be found on the left after the S-bend.

[Link to Google Maps](#)